



# Document Composition Facility

G520-6362-01

## About DCF

Release 4.0

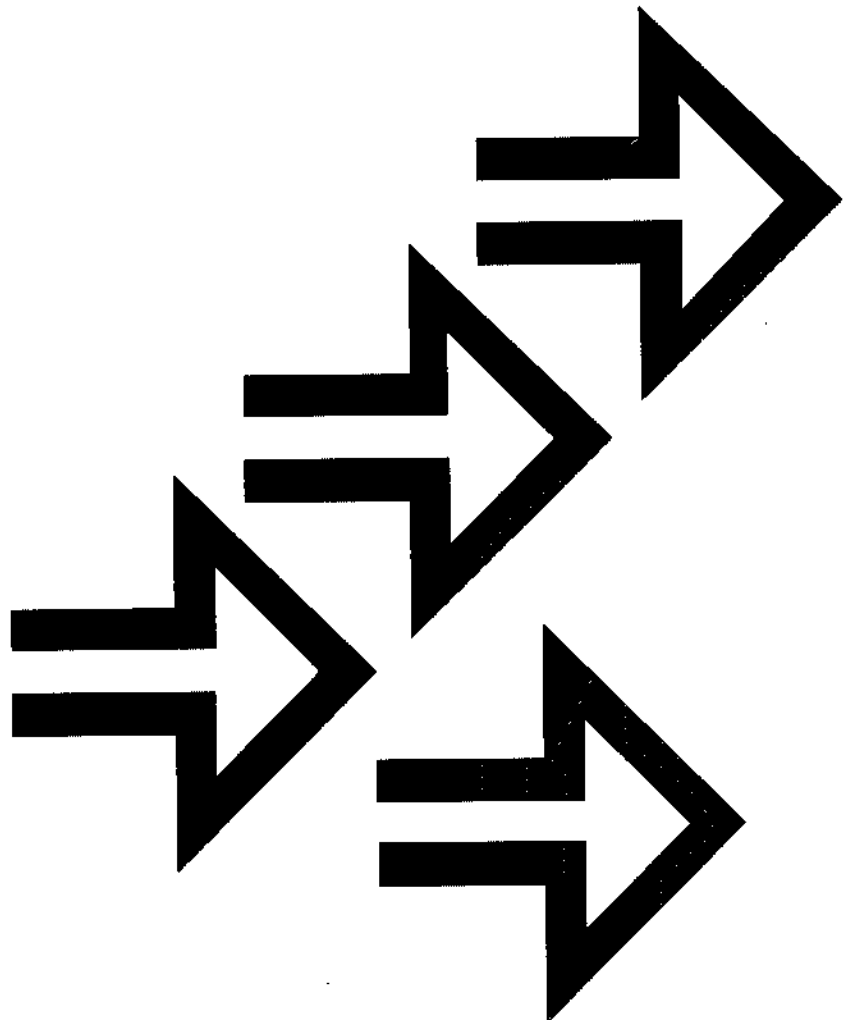









# Document Composition Facility

G520-6362-01

## About DCF

Release 4.0

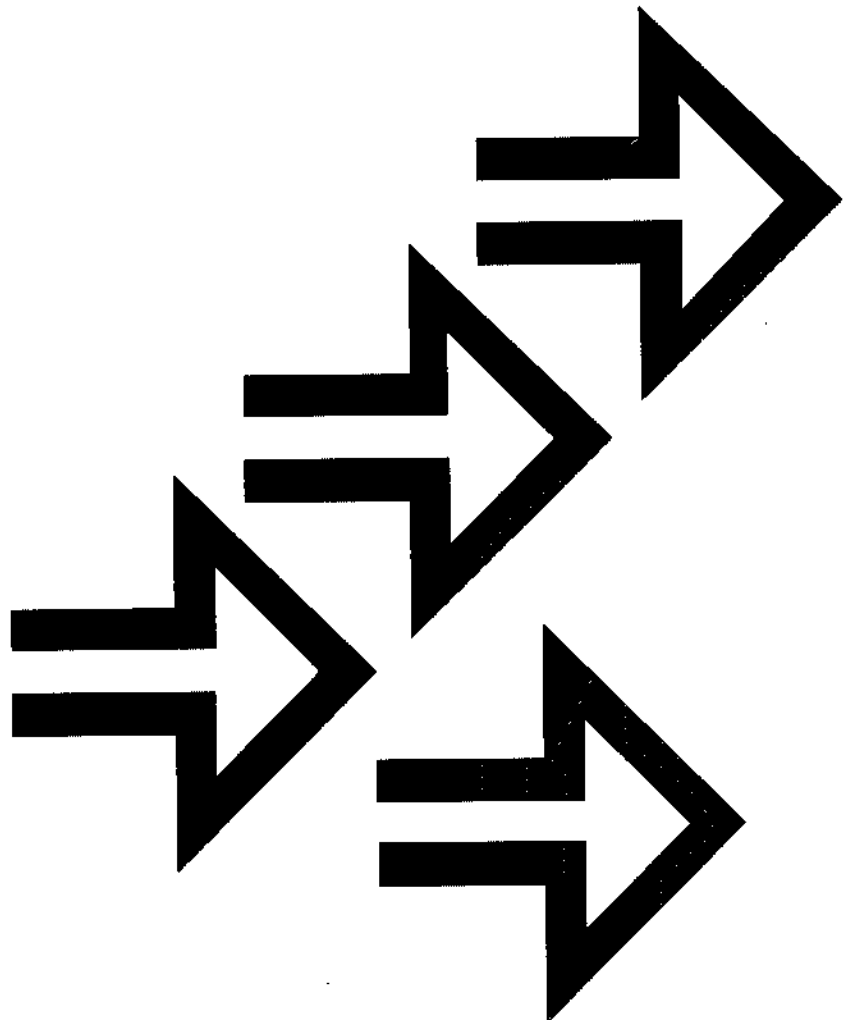



**Note!**

Before using this information and the product it supports, be sure to read the general information in "Notices" on page vii.

**Second Edition (January 1991)**

This is a major revision of G520-6362-0, which is now obsolete. Because this is an extensive revision of this document, no changes have been marked.

This edition applies to Release 4.0 of the IBM Document Composition Facility (DCF) Licensed Program, 5748-XX9, and to all subsequent releases and modifications until otherwise indicated in new editions or Technical Newsletters. Be sure to use the correct edition for the level of the product.

Order publications through your IBM representative or the IBM branch office serving your locality. Publications are not stocked at the address given below.

A form for reader's comments appears at the back of this publication. If the form has been removed, address your comments to:

IBM Corporation  
Information Development  
Department 588  
P.O. Box 1900  
Boulder, Colorado 80301-9191

When you send information to IBM, you grant IBM a nonexclusive right to use or distribute the information in any way it believes appropriate without incurring any obligation to you.

© Copyright International Business Machines Corporation 1987, 1991. All rights reserved.

Note to U.S. Government Users — Documentation related to restricted rights — Use, duplication or disclosure is subject to restrictions set forth in GSA ADP Schedule Contract with IBM Corp.



# Contents

Notices	vii
Trademarks	vii
<b>Introduction to DCF</b>	<b>1</b>
How This Manual Is Organized	1
Information: Your Company's Greatest Asset	1
DCF: A Solution to the Information Management Problem	3
SCRIPT/VS and GML Components	3
DCF and SCRIPT/VS Functions	4
The DCF Operating Environment	6
The Benefits of Automated Document Processing	7
DCF and Advanced Function Printing	8
Use of Typographic Fonts	10
Integration of Text and Graphics	12
An Enhanced Product	14
Self-Study Courses	14
Learn More About DCF Today!	14
<b>Appendix. Related Publications and Products</b>	<b>15</b>
Publication Library Guide for the Document Composition Facility	16
DCF Publications	17
Related Products	17
Optional Features	18
Related Publications	19







## **Figures**

1. How DCF Operates with other AFP Products . . . . .	9
2. Some Examples of Typographic Fonts . . . . .	11
3. Integration of Text and Graphics . . . . .	13







## Notices

References in this publication to products or services of IBM do not suggest or imply that IBM intends to make them available in all countries where IBM does business or that only products or services of IBM may be used. Noninfringing equivalents may be substituted, but the user must verify that such substitutes, unless expressly designated by IBM, work correctly. No license, expressed or implied, to patents or copyrights of IBM is granted by furnishing this document.

---

## Trademarks

The following terms are trademarks of the IBM Corporation in the United States or other countries:

IBM®	Advanced Function Printing™
PSF™	Print Services Facility™
S/370™	IBM 3800 Printing Subsystem Models 3 and 6™
S/390™	IBM 3900 Advanced Function Printer™
AFP™	IBM 3825 Page Printer™
IBM 3827 Page Printer™	IBM 3828 Advanced Function MICR Printer™
IBM 3835 Page Printer™	IBM 3812 Page Printer™
IBM 3816 Page Printer™	IBM LaserPrinter 4028™
IBM 4224-2xx Page Printer™	IBM 4234 Page Printer™
IBM 3820 Page Printer™	IBM LaserPrinter 4019™
IBM 4250 Printer™	ProcessMaster®
BookMaster®	BookManager™
CICS/MVS™	CICS/VS™
VM™	VM/SP™
VM/XA™	VSE™
MVS™	

The following terms are trademarks of other companies as follows:

PostScript	Adobe Systems Incorporated
------------	----------------------------







---

## Introduction to DCF

This booklet provides information about the highlights of the Document Composition Facility (DCF) licensed program (Program Number 5748-XX9).

This booklet is intended for managers of organizations who are potential users of DCF. It will help them evaluate the applicability of DCF for their organization.

**Note:** DCF was used in the preparation of this booklet.

---

## How This Manual Is Organized

The information in this manual is presented in one chapter and one appendix:

"Introduction to DCF" describes today's document processing environment and how IBM's Document Composition Facility can help you improve your company's publications.

Appendix, "Related Publications and Products" on page 15 lists not only the books in the DCF Library and other publications related to this publication, but related products as well.

---

## Information: Your Company's Greatest Asset

The greatest asset your company has is its information. This information is represented in a number of different ways. It can be as simple as an office memo or as complicated as a library of service manuals for a line of products.

Each piece of information your company produces is made up of many different components; it's not just words on a page. An information component is the form in which you represent the information you want to convey. For example, you would want several different information components in a sales brochure. A small sales brochure might include all of the following components:

- Your company's logo
- Graphics showing your product and a map to your location
- Typographic fonts to set off different pieces of information
- Multiple-color printing
- Shaded areas for emphasis
- A schedule or timetable
- Different types of lists
- Bar codes
- Mailing addresses.

If you think about how much your company is relying on the information it produces, you'll see that this information could very well be your most significant corporate asset.



## Information: Your Company's Greatest Asset

With so much relying on your company's information, you can't afford to let that information get out of your control. The way the business environment is today, you could easily lose control of how your information is produced and handled.

For one thing, your firm needs to publish more documents in less time than it has ever had to in the past. The documents you are publishing are often longer and more complex than they've been previously. Your publishing costs are up, including paper and distribution expenses. Requirements for special forms have also increased dramatically.

For another, there is a demand for higher quality publishing. Documents call for effective, attractive use of typography. Users want images and graphics with text. Government regulations and business practices often demand the use of more than one language in printed material.

Another consideration is the decentralization of document processing. More text is being prepared by individual departments, each establishing its own standards. Corporate publishing standards—document styles, editorial guidelines, fonts and typefaces, copy, and format markup—are becoming harder and harder to enforce.

Document accuracy is also under fire. Today's text processing cycle is labor intensive. Errors are a serious problem—key stroke mistakes, transposition faults, the wrong part or price number in a customer document. Documents are often weak in structure and substance. Decentralized, nonstandardized publishing presents a poor image inside and outside the company and lowers the return on any beneficial use of your information asset.

In short, your goals are to:

- Control the effectiveness of your company's document publishing
- Improve the quality of the documents you produce
- Reduce the time it takes to produce them
- Cut your overall production cost.

With the help of IBM's DCF, you can achieve all of these goals.



## DCF: A Solution to the Information Management Problem

A solution to the many problems you face with managing your information assets and maintaining control of your document processing is available. It's available and used worldwide, and it's as close as your mainframe computer. It's IBM's DCF.

DCF is a licensed, general-purpose, text-processing program used in the preparation of printed materials. It consists of a text formatter (SCRIPT/VS) that can format documents that include SCRIPT/VS control words and Generalized Markup Language (GML) tags along with the text. Once processed by SCRIPT/VS, these documents can be printed on a variety of output devices, used as input to the Storage and Information Retrieval System/VS (STAIRS/VS) licensed program, or BookManager.

SCRIPT/VS operates in the following interactive environments when the Foreground Environment Feature of DCF is installed:

- TSO (Time Sharing Option). SCRIPT/VS runs in the TSO foreground. TSO's interactive editing (ISPF/PDF or EDIT) and related facilities provide the text entry, editing, and data set management that are used with SCRIPT/VS for text processing.
- CMS (Conversational Monitor System). CMS's text editors, file system, and related facilities provide the text entry, editing, and file management facilities that are used with SCRIPT/VS for text processing.
- CICS/VS (Customer Information Control System/Virtual Storage). In a CICS/VS environment, an editor such as ATMS-III provides the text entry and editing facilities that are used with SCRIPT/VS for text processing.

You can run SCRIPT/VS in a batch environment (MVS or VSE) by running it as a batch TSO job or under the Document Library Facility (DLF).

## SCRIPT/VS and GML Components

DCF is made up of two basic components: a text formatter called SCRIPT/VS and a descriptive language known as GML. The benefit of using DCF is its text markup capabilities.

Text markup is information you add to your document that enables the text formatter functions of SCRIPT/VS to process it. Both SCRIPT/VS and GML offer ways to markup your text:

- |                           |   |
|---------------------------|---|
| <b><i>Specific</i></b>    | You use SCRIPT/VS control words to indicate exactly how your document is to be formatted.   |
| <b><i>Generalized</i></b> | You use GML tags to describe the different elements of your document (such as headings or paragraphs) without having to specify exactly how those elements are to be formatted. |

Together, SCRIPT/VS and GML provide formatting and document-handling functions that allow for the total composition of your documents. With these capabilities, DCF provides full control over host-based composition functions—plus the flexibility to choose the way a document is described and formatted.



### DCF and SCRIPT/VS Functions

Since many of the functions performed by DCF and SCRIPT/VS overlap, the two terms are occasionally used interchangeably in this section. The main function of SCRIPT/VS is to format text for displaying or printing. SCRIPT/VS provides the capability to produce flexible composition for printing on a computer printer as an alternative to using independent typesetting machines or outside final-document preparation. Through the merging of text and graphics, the user can create a total document for printing on page printers or PostScript devices, for camera-ready output, or for softcopy publications.

The documents to be processed by SCRIPT/VS can be stored in the storage facility being used with the interactive editor or text processor.

It can also be used to format a document so that the output is suitable as input to STAIRS/VS or BookManager.

DCF processing has the following functions:

- Page Layout

You can control the following aspects of page layout:

- Fully proportional vertical and horizontal justification
- Text positioning and alignment
- Text orientation
- Explicit baseline positioning
- Line formatting
- Paragraph formatting
- Page formatting
- Line spacing
- Intercharacter spacing
- Word spacing
- Inline spacing
- Rules
- Typographic fonts
- Including page overlays
- Page segment inclusion
- PostScript image inclusion
- Up to 9 columns (this page is an example of multiple columns)
- Page width
- Adjustable margins

- Indention
- Variable Text
- Headings and Footings—running headings and footings can include:
  - Chapter or section titles
  - Document titles or form numbers
  - Page numbers
  - Security classifications.
- Bar code tag set to allow page printers to print bar codes
- Memo tag set
- Overhead-transparency tag set
- Schedule tag set
- SCRIPT Mathematical Formula Formatter (SMFF) optional feature
- MVS and VM extended architecture exploitation
- Shading
- Input file size for VM
- Page number symbols
- Separation masters for multiple color printing and multi-part forms
- Uppercase string translation
- Tables
- Heading levels
- Table of contents generation
- Index generation
- Highlighted phrases
- Footnotes<sup>1</sup>
- Hyphenation, spelling verification, starter set translation, and index sort sequences in 15 languages
- Selective printing of parts of a document
- Tab handling
- Box drawing
- Keeping text together
- Floating text to the top or bottom of a page or column

---

<sup>1</sup> This is an example of the footnote function.



- Generalized Markup Language (GML)
- Saving input lines for subsequent processing
- Input line prefixing
- Revision codes, their fonts, and their character alignment
- Combining separate input files
- User interaction during processing
- Use as a subroutine of an application program
- Symbol and macro-instruction processing
- Various output destinations and logical devices
- Support for the PostScript page description language
- Multi-pass formatting
- Variable text
- Post-processing examples for page printers
- Copy-group selection
- Hexadecimal-character generation
- Widow control
- Conditional processing
- Interacting during processing
- Designating destination of output
- Adding text to output
- Using SCRIPT/VS as a subroutine
- Tracing processing actions for debugging



---

### The DCF Operating Environment

DCF is designed to be used on a host-based or distributed system environment. This design offers a number of advantages.

DCF resides on your IBM mainframe host computer or on distributed systems. Adding it is as simple as adding any other software to your installation. It runs in an interactive environment under the control of the specified releases of CMS, TSO, or CICS and the processors on which they are designed to operate. DCF operates in a batch environment on all IBM System/370 Models 138 and above, the IBM System/390, the IBM 3032 Processor and above, and the IBM 4332, 4341, 4361, 4381, and 9370 processors that are supported by VSE or MVS. Floating-point hardware is required.

DCF is supported by and supports multiple input and output devices, including a wide range of IBM displays and printers. Your company's information can be entered and edited on a variety of host-attached terminals or distributed office systems that attach to the host. DCF maximizes the use of Advanced Function Printing (AFP) equipment you may already have installed.

Using DCF ensures that you have access to all the benefits of a host environment in your document processing. Your end users have all the benefits of host connection, including access to mainframe data bases and data communications capability with full security provisions.

The host-based capability and flexibility of DCF can help you enforce publishing standards throughout your organization. You can determine and standardize the corporate "look" of your documents. For example, the use of GML "tags" is fully controlled by a text administrator, generally someone on a centralized staff. Along with a text programmer, who may be the same person, the text administrator helps control the use of document standards throughout a department, division, or entire company.



---

## The Benefits of Automated Document Processing

Some of the benefits of automated document processing are:

- You can produce complete documents faster.
- It's simpler to update your documents.
- Each revision or draft of your document requires less proofreading.
- You can merge text and graphics throughout your document.
- You have the flexibility to use different formats or document styles for your information without altering the information or markup.
- You have a database of common information you can use throughout all of your documentation.

To gain these benefits in a host-based or distributed environment, you'll need to use the following:

- Some kind of text editor (either host or PC based), word processor, or workstation publishing system for entering and updating your information.
- A library for storing and accessing your documents.
- A text formatter to interpret the markup or information added to your document for processing.
- A tool for creating graphics and images.
- Devices for displaying or printing your output.

DCF works in conjunction with IBM's Advanced Function Printing and other IBM products to automate your document processing by providing the capabilities to markup and format your text.



---

## DCF and Advanced Function Printing

DCF is a part of IBM's Advanced Function Printing (AFP) architecture—a group of IBM products that work together with computers to enhance the appearance of documents and reduce the cost of printing.

AFP includes licensed programs such as DCF and the IBM family of non-impact, all-points-addressable (APA) page printers. AFP enhances the quality of your finished documents, reduces the cost of publishing, and dramatically alters the creation and cost of forms in your organization. It can also help you get better use from the accurate text you already have stored in your mainframe environment. Figure 1 on page 9 illustrates how DCF operates with other AFP products.

These benefits are largely the result of all-points-addressable (APA) printing. With IBM AFP printers, data can be placed at any addressable point on a page rather than just at line and character positions. This increases your ability to produce virtually any combination of words and pictures on a printed page. AFP page printers allow you to use:

- Typographical fonts of varying sizes and rotations
- Electronically-designed forms
- Graphics, such as line art, illustrations, photographs, logos, and signatures.

You can generally print the same document on any one of IBM's AFP family of page printers without changing the source, although there are some functional differences among these printers (for example, the valid printable area on the page varies from printer to printer). The IBM family of AFP page printers include:

- IBM 3800 Printing Subsystem Models 3 and 6
- IBM 3820 Page Printer
- IBM 3825 Page Printer
- IBM 3827 Page Printer
- IBM 3828 Advanced Function MICR Printer
- IBM 3835 Page Printer
- IBM 3812 Page Printer
- IBM 3816 Page Printer
- IBM LaserPrinter 4028
- IBM 3900 Advanced Function Printer
- IBM 4224-2xx Page Printer
- IBM 4234 Page Printer

and any other printer compatible at the datastream level.



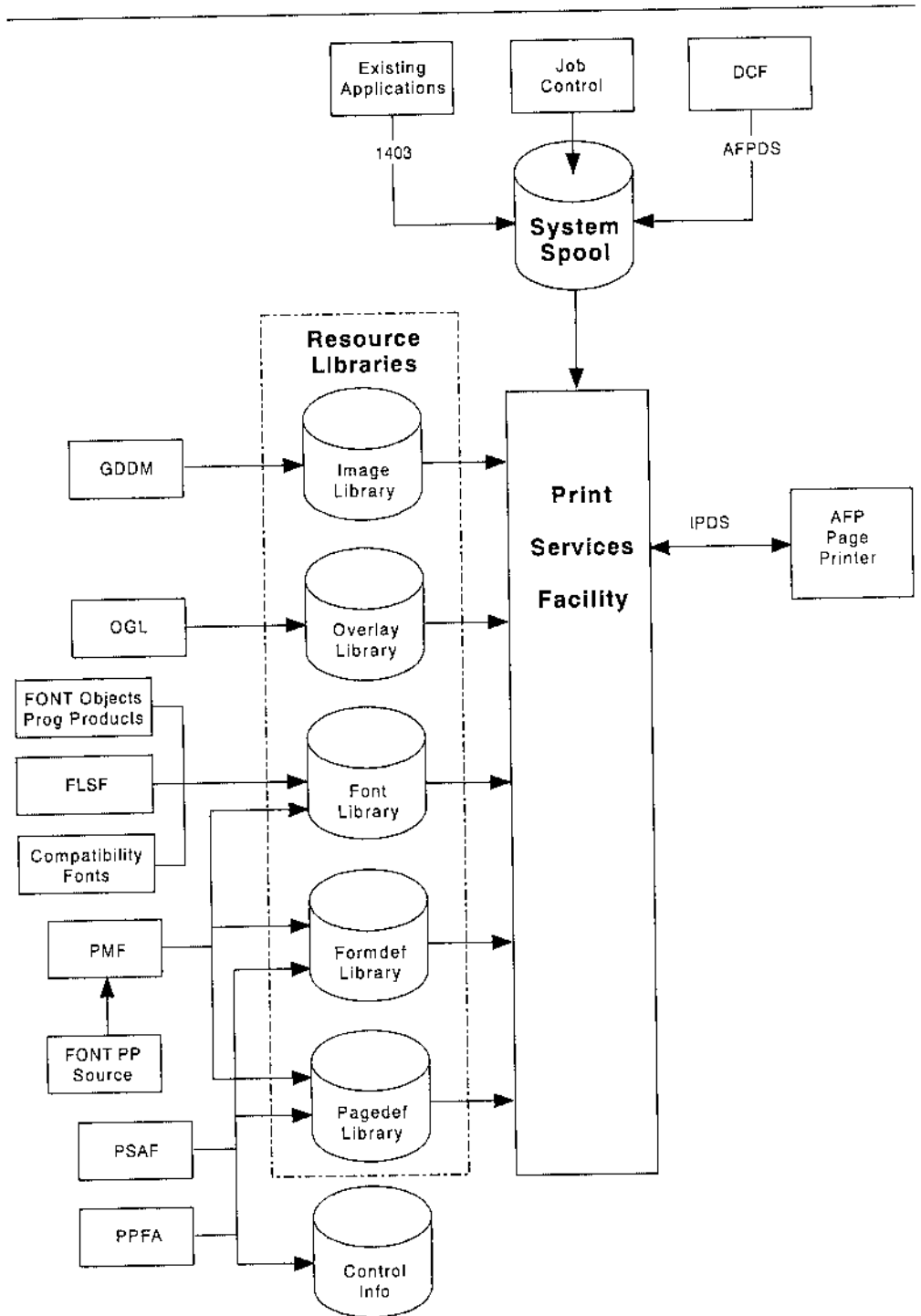

Figure 1. How DCF Operates with other AFP Products



---

### Use of Typographic Fonts

With the combination of DCF and the capabilities of AFP printers, you can use *typographic fonts* of varying sizes and widths in your printed documents. Studies show that typography vastly expands the potential of printed communication.

- It makes messages more legible and readable.
- It commands attention to ideas.
- It increases comprehension.
- It cuts costs.

When you use typographic fonts, your ideas attain visible distinction and clarity. The personality of varied typefaces invites reading and enhances emotional appeal. Typographic fonts increase legibility by distinguishing between characters. They enhance the readability of your documents by using different typefaces for different elements such as headings, text, captions, and footnotes. For example, this document was composed using DCF and AFP.

In fact, people comprehend complex messages faster when a document has been prepared with typographic fonts. Typographic fonts also save space on a page—leading to important savings when a document is reproduced in large quantities.

With DCF, you can print your text in a variety of typographic fonts and character heights (point sizes) on IBM AFP printers that produce documents with typeset-quality resolution. The result is a major step toward higher quality publishing.



Courier  
**Courier Bold**  
*Courier Italic*  
8 point

ITC Avant Garde Gothic  
**ITC Avant Garde Gothic Bold**  
*ITC Avant Garde Gothic Bold Italic*  
14 point

Monotype Century  
**Monotype Century Bold**  
*Monotype Century Bold Italic*  
20 point

Helvetica  
**Helvetica Bold**  
*Helvetica Bold Italic*  
30 point

Souvenir  
**Souvenir**  
*Souvenir*  
60 point

Figure 2. Some Examples of Typographic Fonts



---

### Integration of Text and Graphics

Another ability you gain by using DCF and AFP or PostScript is the *integration of text and graphics* in your documents. (For example, this document was prepared using DCF in concert with other AFP products and was printed on a PostScript device.) In most conventional printing, text and graphics are often printed separately and manually merged onto a single sheet of paper in a cut-and-paste operation. In the past, quality printed output of formatted text and graphics often required photocompositors or graphic plotters.

With AFP printers and DCF, you can incorporate images and graphics in your documents. Engineering drawings, assembly diagrams, illustrations, and halftone images all can now be embedded in your documents. You can even include logos and signatures with your text. The result, again, is better quality documents produced faster at a lower overall cost.



**Input Bin Pickup Roller Drive Belt**

**REMOVE:** This removal can be done with the input bin in the machine.

1. Lower the elevator table.
2. Remove the covers from the input bin (front, rear, and top).
3. Disengage the forward feed roller assembly by spreading the spring clip on the pickup-roller bracket shaft, and pulling out the shaft (see the figure below).
4. Remove the front pickup roller by loosening the setscrew.
5. Remove the front screw that fastens the front bracket and slide the front bracket of the forward feed roller assembly toward the front of the machine.

6. Remove the retaining clips from the two shafts.
7. Remove the screws that fasten the bearing at the front of the forward feed roller shaft.
8. Remove the bearing.
9. Remove the old belt from the shaft, and install a new one.

**INSTALL:**

Reassemble the pickup roller assembly by reversing the removal procedure.

**Note:** The separating rollers can be pulled clear of the forward feed rollers by reaching through the jam access opening (below knob A).

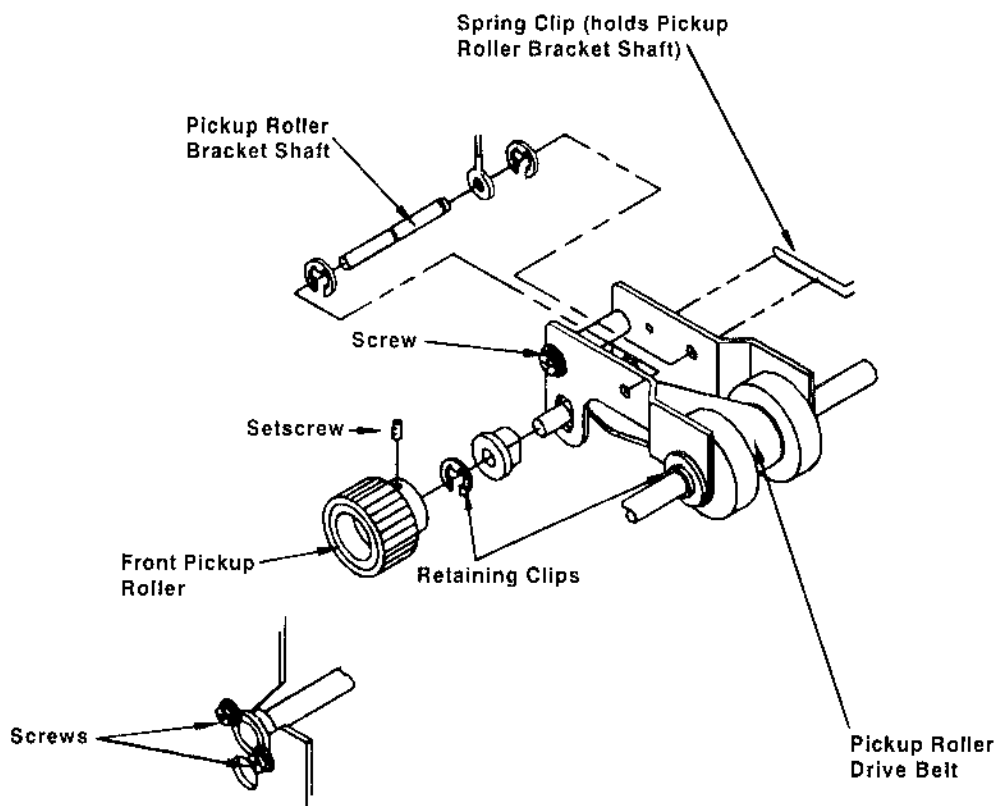

Figure 3. Integration of Text and Graphics



---

## An Enhanced Product

DCF has recently been enhanced. Release 4.0 adds a number of features, from support for shading of boxes, areas, and table cells on AFP printers and PostScript devices to allowing for construction of masters for multiple-color printing and multi-part forms. All features and enhancements are fully compatible with earlier releases and functions of DCF. A list of major DCF functions is included in "DCF and SCRIPT/VS Functions" on page 4.

---

## Self-Study Courses

DCF is supported by these separately orderable self-study courses:

- *Using the Document Composition Facility*, SR21-0515 (Training Course 32291).
- *Using DCF with Page Printers*, SR21-1211 (Training Course 32243).
- *Document Composition Facility—Release 3 (SCRIPT/VS) for Document Administrators and Text Programmers*, SR20-7525 (Training Course).
- *Document Composition Facility (SCRIPT/VS) Student Text*, SC20-1894 (Training Course).

These courses are designed for people with the primary responsibility for using DCF, supporting DCF, performing document analysis, setting standards, and educating end users. With this training, your text programmers and administrators learn how to analyze your needs and implement DCF effectively in your organization.

---

## Learn More About DCF Today!

This book has given you a brief introduction to IBM's Document Composition Facility. For more information about DCF and a list of DCF publications and related products, see *Document Composition Facility: General Information*, GH20-9158. To learn more about how DCF can help you improve the quality and cut the cost of document publishing, contact your IBM marketing representative today.



---

## Appendix. Related Publications and Products



## Publication Library Guide for the Document Composition Facility

The following table lists the Document Composition Facility publications by number as they relate to user tasks. "DCF Publications" on page 17 lists the titles and the order numbers that correspond to the numbers listed in the table.

Number	User Tasks	Typical Audience	Brief Description
(1) (2) (3) (20)	Planning and introducing DCF/DLF	Users, system planners	Provide a general overview of text processing, library facility, and available books.
(3) (4) (5) (12) (16) (20)	Formatting documents (using the GML starter set)	Novice to experienced end users	Provide an introduction to the Generalized Markup Language (GML) starter set and describes the GML starter set tags and SCRIPT/VS messages.
(6)	Creating bar codes with DCF/GML	Experienced end users	Provides information about using GML to create bar codes.
(9) (10) (11) (12) (17) (18) (19) (21)	Formatting documents (using SCRIPT/VS control words)	Knowledgeable to experienced end users	Describe the function and use of all SCRIPT/VS control words, macros, diagnostic aids, and the formatting features and messages.
(14) (15)	Converting RFTDCA for SCRIPT/VS formatting	Novice to experienced RFTDCA users	Describe the function and use of the optional Office Document Feature, including diagnostic aids and messages.
(4) (5) (7) (9) (10) (11) (19)	Modifying GML starter set <sup>2</sup>	Document administrator and text programmer <sup>3</sup>	Contain material about GML starter set tags, SCRIPT/VS control words, and GML starter set modifications.
(4) (5) (7) (8) (9) (10) (11) (16) (19)	Creating GML application processing functions	Document administrator and text programmer <sup>3</sup>	Provide information about designing your own GML and about GML concepts, GML starter set tags, SCRIPT/VS control words, and usage guidelines.
(10) (11) (12) (13) (19) (24) (25) (26) (27) (28) (29)	Installing, modifying, and maintaining DCF	System programmer	Give information on error isolation, program tailoring, and use of SCRIPT/VS.
(22)	Creating mathematical formulas with SMFF	Experienced end users	Describes the function and use of the SCRIPT Mathematical Formula Formatter (SMFF), including .EQ control word and messages.
(23)	Creating memos, transparencies, and schedules with GML applications	Novice to experienced end users	Describes the use of the memo, transparencies, and schedule applications, including messages.

<sup>2</sup> Central Programming Service support and maintenance are provided **only** on the unmodified GML applications shipped with DCF. If you modify any of these GML applications shipped with DCF, it is recommended that you also maintain an **unmodified** copy for diagnostic purposes.

<sup>3</sup> The document administrator is responsible for defining markup conventions and procedures for an organization. The text programmer implements application processing functions (APFs) that provide the processing specified by the document administrator.



## DCF Publications

Number	Titles and Order Numbers
(1)	<i>About DCF</i> , G520-6362.
(2)	<i>Document Composition Facility and Document Library Facility General Information</i> , GH20-9158.
(3)	<i>Document Composition Facility: Introduction to Generalized Markup Language</i> , G544-3192.
(4)	<i>Document Composition Facility: Generalized Markup Language Starter Set User's Guide</i> , SH20-9186.
(5)	<i>Document Composition Facility: Generalized Markup Language Starter Set Reference</i> , SH20-9187.
(6)	<i>Document Composition Facility: Bar Code User's Guide</i> , S544-3115.
(7)	<i>Document Composition Facility: Generalized Markup Language Starter Set Implementation Guide</i> , SH35-0050.
(9)	<i>Document Composition Facility: SCRIPT/VS User's Guide</i> , S544-3191.
(10)	<i>Document Composition Facility: SCRIPT/VS Text Programmer's Guide</i> , SH35-0069.
(11)	<i>Document Composition Facility: SCRIPT/VS Language Reference</i> , SH35-0070.
(12)	<i>Document Composition Facility: SCRIPT/VS Messages</i> , SH35-0048.
(13)	<i>Document Composition Facility: Diagnosis Guide and Reference</i> , LH40-0209.
(14)	<i>Document Composition Facility: Office Document Feature User's Guide</i> , G544-3129.
(15)	<i>Document Composition Facility: Office Document Feature Reference</i> , S544-3130.
(16)	<i>Using the Document Composition Facility</i> , SR21-0515 (Training Course 32291).
(17)	<i>Using DCF with the 4250 Printer</i> , SR20-8486 (Training Course 32908).
(18)	<i>Using DCF with Page Printers</i> , SR21-1211 (Training Course 32243).
(19)	<i>Document Composition Facility—Release 3 (SCRIPT/VS) for Document Administrators and Text Programmers</i> , SR20-7525 (Training Course).
(20)	<i>Document Composition Facility (SCRIPT/VS) Student Text</i> , SC20-1894 (Training Course).
(21)	<i>Document Composition Facility: TSO Enhancements Update Guide</i> , G544-3345.
(22)	<i>Document Composition Facility: SCRIPT Mathematical Formula Formatter User's Guide</i> , S544-3306.
(23)	<i>Document Composition Facility: Generalized Markup Language (GML) Applications User's Guide</i> , G544-3305.
(24)	<i>Document Composition Facility: MVS Program Directory</i> , G544-3669.
(25)	<i>Program Directory for use with DCF and SMFF for VM</i> , G544-3670.
(26)	<i>Document Composition Facility: VSE Program Directory</i> , G544-3671.
(27)	<i>Document Composition Facility: ODF Program Directory for MVS</i> , G544-3687.
(28)	<i>Document Composition Facility: ODF Program Directory for VM</i> , G544-3686.
(29)	<i>Document Composition Facility: SMFF Program Directory for MVS</i> , G544-3685.

The following are also available:

- *Document Composition Facility: GML Starter Set Quick Reference*, SX26-3723.
- *Document Composition Facility: SCRIPT/VS Text Programmer's Quick Reference*, SX26-3719.
- *Document Composition Facility Post-Processor Examples*, S544-3484.
- *Document Composition Facility*, SH35-0086 (binder).

**Note:** The DCF publications will be available at the end of the second quarter of 1991 as displayable BookManager built BOOKs and as source files on a CD-ROM, SK25-1980.

## Related Products

The following products are related to DCF. For information about ordering any of these products, contact your local IBM Branch Office.

- **MARKUP:** A PC-based editor that helps you create GML documents. Refer to *MARKUP User's Guide and Tutorial*, which you can order with the MARKUP product, 6476161.
- **Publishing Systems BookMaster:** A host-based application that runs under control of DCF and is designed for high-volume in-house publishing applications. This application contains a superset of the GML Starter Set.



## Optional Features

- **Publishing Systems BookManager BUILD and BookManager READ:** Host-based IBM licensed programs that let you create and use online books and documents at your terminal in a VM/CMS system.
- **OfficeVision:** OfficeVision provides an integrated electronic office that delivers a broad range of office functions for business communications with the help of an integrated set of services.
- **Standard Generalized Mark-up Language (SGML) TextWrite OS/2 Edition:** TextWrite is a software program that writers can use to create and modify SGML-compliant documents.
- **TextTagger:** TextTagger is a software program that analyzes electronic documents and inserts tagging to comply with the Department of Defense's Computer-Aided Acquisition and Logistics Support (CALS) initiative.
- **SGML Translator DCF Edition:** A program that parses, validates, and translates SGML documents so they can be formatted and printed by DCF.
- **Print Services Facility (PSF):** A licensed program that combines print data with resources to manage and control data transmitted to IBM page printers.

---

## Optional Features

For information about ordering these optional features, contact your local IBM Branch Office:

- **SCRIPT Mathematical Formula Formatter (SMFF):** An optional feature of DCF that can be ordered separately. SMFF makes it possible to construct and display mathematical and scientific formulas on page printers.
- **Office Document Feature (ODF):** An optional feature of DCF that can be ordered separately. ODF allows documents that have been created with an office system to be printed on DCF-supported printers.



---

## Related Publications

You should use the following publications to evaluate the use of DCF in different operating environments:

- *IBM Virtual Machine/System Product: Introduction*, GC19-6200.

This publication contains an introduction to CMS (Conversational Monitor System), which is one of the interactive systems that SCRIPT/VS operates with.

- *IBM Virtual Machine/System Product: Terminal User's Guide*, GC19-6206.

This publication describes the various terminal types supported by VM/SP for those who plan to use VM/SP in their operations.

- *OS/VS2 TSO Terminal User's Guide*, GC28-0645.

This publication gives detailed user information about OS/VS2 TSO (Time Sharing Option), which is one of the interactive systems that SCRIPT/VS operates with. It describes the TSO EDIT facility and related facilities for text entry, text editing, and data set management.

- *A Guide to IBM's Advanced Function Printing*, G544-3095.

This publication describes the use of a licensed program (PSF, DCF, GML, OGL, GDDM, and PMF) and the use of a subset of a licensed program in conjunction with the IBM Advanced Function Printing (AFP) printers, including the IBM 3800 Printing Subsystem Models 3 and 6 and the IBM 3820 Page Printer.

- *Advanced Function Printing Software: General Information*, G544-3415.

This publication defines Advanced Function Printing (AFP), describes the features and functions of the AFP licensed programs, and shows how the programs work together. It is intended for the people in your organization who will plan for, install, use, and maintain IBM's AFP software products. It also contains a list of the AFP publications.

If you install DLF in the MVS environment, you need a copy of *OS/VS2 Access Method Services*, GC26-3841.

If you install DLF in the VSE environment, you need a copy of *VSE/VSAM Access Method Services: User's Guide and Reference*, SC24-5144.













Fold and Tape

Please do not staple

Fold and Tape



NO POSTAGE  
NECESSARY  
IF MAILED IN THE  
UNITED STATES



## BUSINESS REPLY MAIL

FIRST CLASS MAIL PERMIT NO. 40 ARMONK, NEW YORK

POSTAGE WILL BE PAID BY ADDRESSEE

International Business Machines Corporation  
Information Development  
Department 588  
P.O. Box 1900  
Boulder, CO 80301-9191



Fold and Tape

Please do not staple

Fold and Tape









File Number: S370-20  
Program Number: 5748-XX9

Printed in U.S.A.



G520-6362-01

